

Enphase® Frame Mount

A Frame Attach Solution That Makes Installations Quick, Easy, and More Affordable

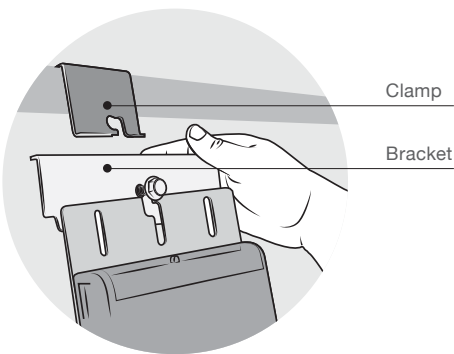

- 1** Place the clamp
Simply place the clamp over the edge of the module frame.

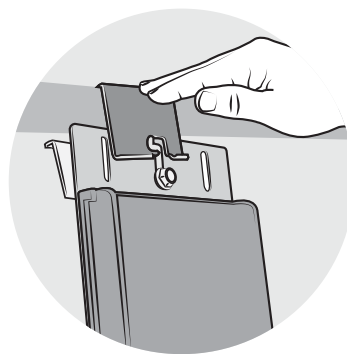

- 2** Lock it in
With the cap screw threaded into the bracket, slide the Enphase Microinverter on top of the bracket.



- 3** Bolt it down
With the bracket under the clamp, tighten the cap screw with a half-inch socket wrench.

Features

Makes Enphase Microinverters Compatible with Railless and Ballasted Systems

- Bolts microinverters directly to the module frame, eliminating design challenges with both residential and commercial systems
- Comes in two sizes that fit the majority of modules

Faster Installations

- Bolt microinverters to module frames on the ground, then carry the complete module up to the roof for rapid, drop-in installation
- Simple, two-piece bracket attaches in three easy steps

More Affordable

- Installing with the Enphase Frame Mount requires fewer parts than other frame mount solutions, saving you material costs
- Reduce labor costs with faster, more efficient installations

Reliable

- The Enphase Frame Mount is made of anodized aluminum for a strong, rust-free bracket
- Engineered specifically for use with Enphase Microinverters

Enphase® Connector Clip

An Effective Cable Management Solution for the Enphase Cabling System

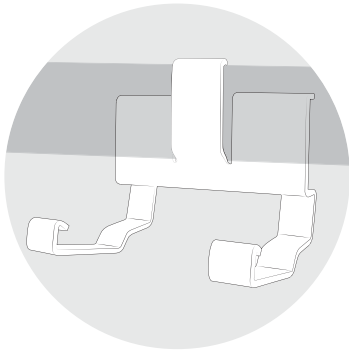

1 Choose the location

Position the Connector Clip where you want to attach it on the module frame.

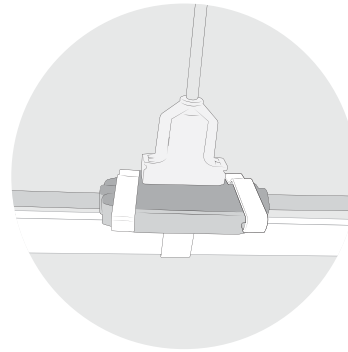

2 Attach it

Press down to snap the Engage Cable into place.

Features

Effective Cable Management

- Enables effective cable management by securing the Engage Cable System directly to module frames
- Fits any size module

Faster Installations

- Attach the Enphase Connector Clip to module frames on the ground, then carry the complete module up to the roof for rapid, drop-in installation

More Affordable

- A single part solution for cable management, resulting in cheaper installations
- Use on railless and ballasted systems for cable management, providing a more affordable alternative

Reliable

- The Enphase Connector Clip is made of anodized aluminum for a strong, rust-free clip
- Engineered specifically for use with the Engage Cable System